

# Instructions For Returning A Splendide Combination Washer-Dryer

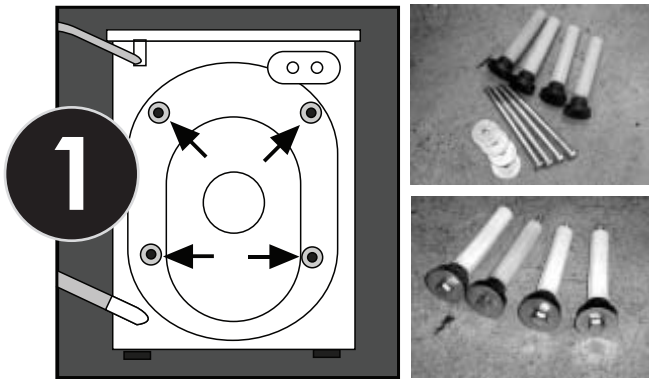

## 1 Reinstall Transit Brackets

Reinstall set of four transit screws, rubber grommets, and plastic spacers.

**ATTENTION!** *DO NOT* over tighten transit screws! Damage to drum will occur! Screws should be snug, not tight.



## 2 Install Styro Packing

### Install Styro Packing

To install Styro Packing (provided). Top, bottom and all four corner pieces must be used to avoid fright damage.



## 3 Assemble & Install Carton

### Assemble & Install Carton

Assemble carton (provided). Slide it down over the top of the machine. *NOTE: Open end of carton is at the bottom.*



## 4 Band/Tape Boxed Machine

### Band/Tape Boxed Machine

Band or tape boxed machine to ensure that Styro piece can't be removed during shipment.



## 5 Band to Skid

### Band to Skid

Band boxed machine to suitable pallet for protection against damage from any side during shipment.

**Splendide Div. Westland Sales**  
Corporate Headquarters 15650 SE 102nd  
Ave. Clackamas, OR 97015 - USA  
Phone: 503.655.2563 Fax: 503.656.8829  
e-Mail: splendide@westlandsales.com  
Web: www.splendide.com

**Splendide**<sup>®</sup>  
"Where Technology Meets Ecology"

*Westland Sales cannot and will not be responsible for damage occurring as the result of improper packing and/or shipping procedures. All freight damaged units will be subject to refusal upon inspection. Please contact us if you have any questions, or need further assistance.*